



PS165P10Y◆1



PS165Z10Y◆1



PS161P10Y◆1



PS165P10Y◆1▲▲

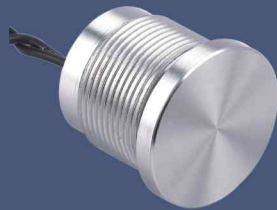

PS193P10Y◆1



PS193Z10Y◆1



PS193P10Y◆1▲▲T



PS193P10Y◆1▲▲L



PS223P10Y◆1



PS223Z10Y◆1

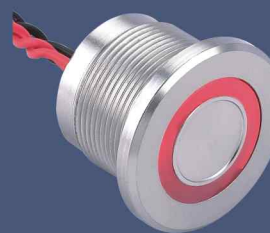

PS223P10Y◆1▲▲T



PS225P10Y◆1▲▲L

Environmental specifications

- Sealing : IP68
- Vibration resistance : 10-500 Hz / 10 g
- Operating temperature : -40°C to +75°C

Materials

- Case : aluminium, anodized
- Multi-wire leads section 0,22 mm² length 300 mm, twisted by pair
- Cable, length 300 mm, section depending on switch model
- PC terminals : bronze, tin plated

Electrical and general specifications

- Max. current/voltage rating : 1A 24VAC/DC or 200mA 24VAC/DC depending on version
- Switch resistance ON : 10 max.
- Switch resistance OFF : 5M min.
- Operating force : 2 to 6N
- Life expectancy : 50 million cycles
- LED consumption : Illuminated dot : 10mA - Illuminated ring : 20mA

Implication of Type

PS	16	★	□	□	◆	□	△	▲
Series	Mounting dimensions	Operator 5P Flat operator, height 4,5 1P Flat operator, height 1.0 (non illuminated) 5Z With finger location, height 4,5 (non-illuminated)	Electrical function 10 NO (pulse)	Terminals Y Lead(length 30mm) Other Lead length and connection mode can be customized.	Colours / Materials 0 Natural anodized 1 Black anodized 2 Blue anodized 3 Gold anodized 4 Red anodized S Stainless steel 316L	Switch ratings 1 200mA 24VAC/DC	LED colour Blank Non-illum. R Red G Green Y Yellow O Orange B Blue W White	Lamp voltage Blank Non-illum. 05 Standard ring - 5VDC 12 Standard ring - 12VDC 24 Standard ring - 24VDC

PS	19	★	□	□	◆	□	△	▲
Series	Mounting dimensions	Operator 3P flat operator, height 3.0 3Z with finger location, height 3.0	Electrical function 10 NO (pulse)	Terminals Y Lead(length 30mm) Other Lead length and connection mode can be customized.	Colours / Materials 0 Natural anodized 1 Black anodized 2 Blue anodized 3 Gold anodized 4 Red anodized S Stainless steel 316L	Ratings 1 200mA 24VAC/DC	LED colour Blank Non-illum. R Red G Green Y Yellow O Orange B Blue W White	Lamp voltage Blank Non-illum. 05T thin ring - 5VDC 12T thin ring - 12VDC 24T thin ring - 24VDC 05L large ring - 5VDC 12L large ring - 12VDC 24L large ring - 24VDC

PS	22	★	□	□	◆	□	△	▲
Series	Mounting dimensions	3P Flat operator, height 3.0 (Not available with large illuminated ring.) 3Z With finger location, height 3.0, (Not available with illuminated ring). 5P Flat operator, height 4.5 (Available with large illuminated ring only.)	Electrical function 10 NO (pulse)	Terminals Y Lead(length 30mm) Other Lead length and connection mode can be customized.	Colours / Materials 0 Natural anodized 1 Black anodized 2 Blue anodized 3 Gold anodized 4 Red anodized S Stainless steel 316L	Ratings 1 200mA 24VAC/DC	LED colour Blank Non-illum. R Red G Green Y Yellow O Orange B Blue W White	Lamp voltage Blank Non-illum. 05T thin ring - 5VDC 12T thin ring - 12VDC 24T thin ring - 24VDC 05L large ring - 5VDC 12L large ring - 12VDC 24L large ring - 24VDC 05D dot - 5VDC 12D dot - 12VDC 24D dot - 24VDC

Finger pressure applied to switch

1 = pressure
0 = no pressure

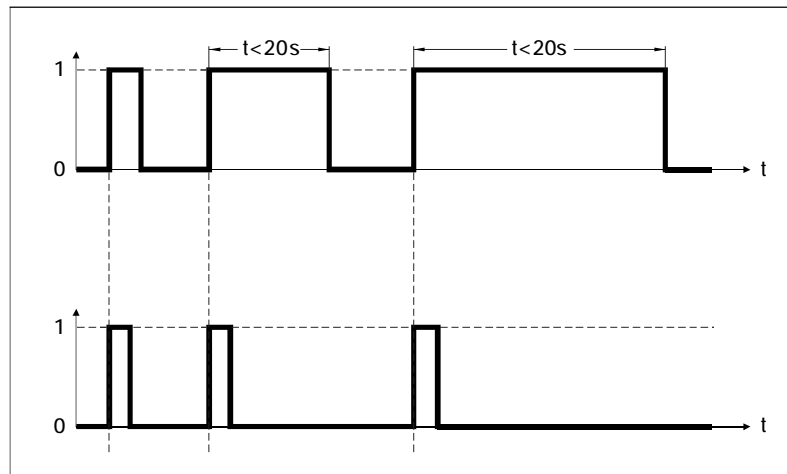

Output

- Momentary NO (pulse)
No external power supply required

Wiring diagrams

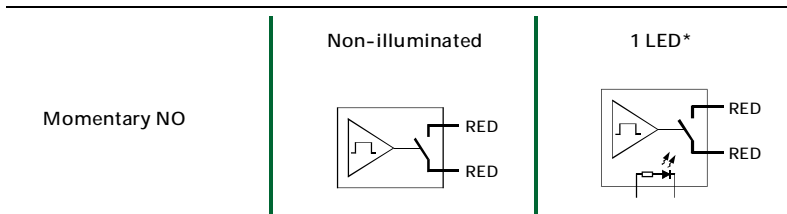

Non-illuminated, operator height 4.50mm, flat



PS165P10Y◆1

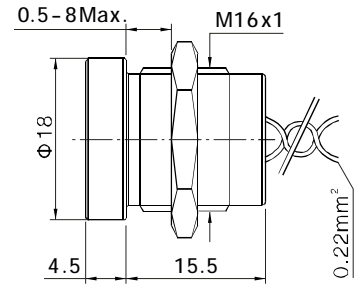

Non-illuminated, operator height 4.50mm, with finger location



PS165Z10Y◆1

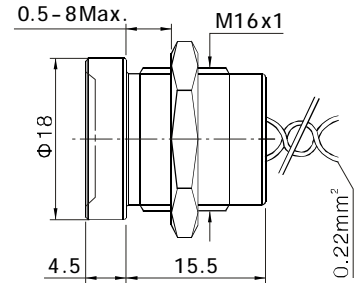

Non-illuminated, operator height 1mm, flat



PS161P10Y◆1

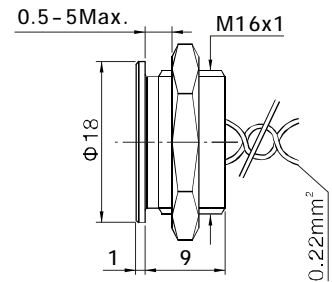

With standard illuminated ring, operator height 4.50mm, flat



PS165P10Y◆1△▲

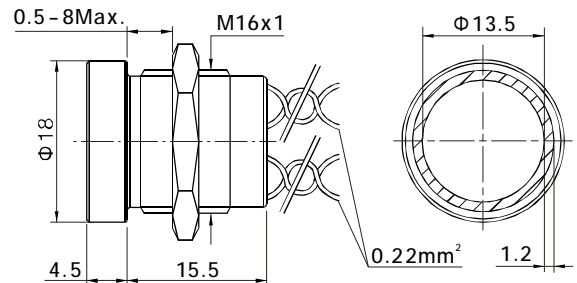

◆ Colours / Materials
 0 Natural anodized
 1 Blue anodized
 2 Black anodized
 3 Gold anodized
 4 Red anodized
 S Stainless steel

△ LED colour
 Blank Non-illum.
 R Red
 G Green
 Y Yellow
 O Orange
 B Blue
 W White

▲ Lamp voltage
 Blank Non-illum.
 05 Standard ring - 5VDC
 12 Standard ring - 12VDC
 24 Standard ring - 24VDC

Non-illuminated - operator height 3mm, flat



PS193P10Y◆1

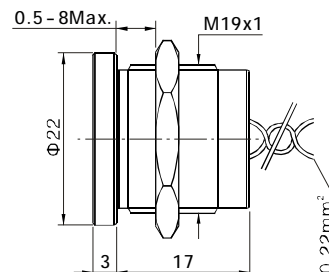

Non-illuminated - operator height 3mm, with finger location



PS193Z10Y◆1

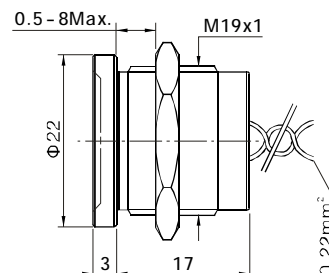

With thin illuminated ring, operator height 3mm, flat



PS193P10Y◆1▲▲T

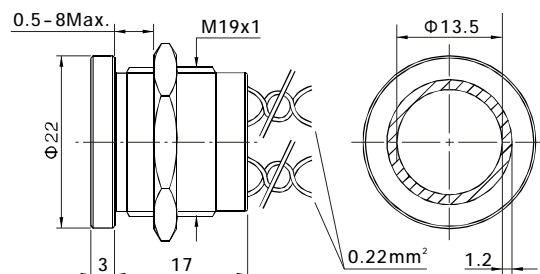

With large illuminated ring, operator height 3 mm, with chamfer



PS193P10Y◆1▲▲L

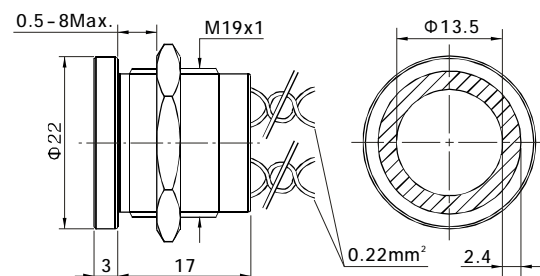

◆ Colours / Materials	△ LED colour	▲ Lamp voltage
0 Natural anodized	Blank Non - illum.	Blank Non - illum.
1 Blue anodized	R Red	05T thin ring - 5VDC
2 Black anodized	G Green	12T thin ring - 12VDC
3 Gold anodized	Y Yellow	24T thin ring - 24VDC
4 Red anodized	O Orange	05L large ring - 5VDC
S Stainless steel	B Blue	12L large ring - 12VDC
	W White	24L large ring - 24VDC

Non-illuminated, operator height 3 mm, flat



PS223P10Y◆1

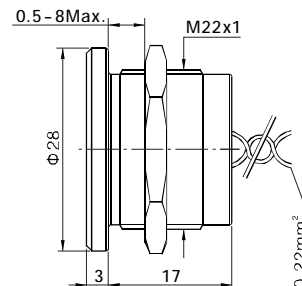

Non-illuminated, operator height 3 mm, with finger location



PS223Z10Y◆1

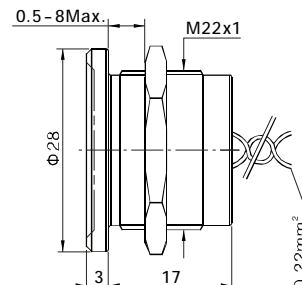

With thin illuminated ring - operator height 3 mm, flat



PS223P10Y◆1▲▲T

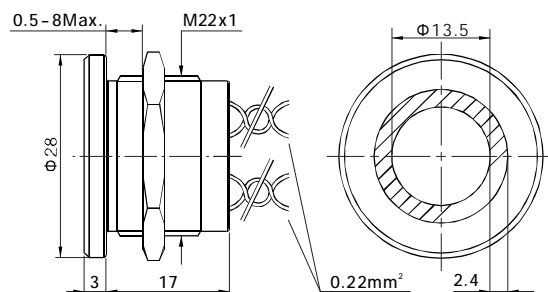

With large illuminated ring, operator height 4.50mm, flat



PS225P10Y◆1▲▲L

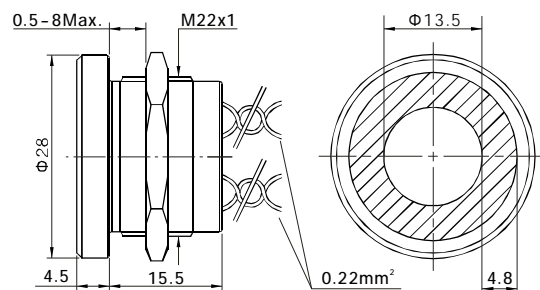

◆ Colours / Materials
 0 Natural anodized
 1 Blue anodized
 2 Black anodized
 3 Gold anodized
 4 Red anodized
 S Stainless steel

△ LED colour
 Blank Non-illum.
 R Red
 G Green
 Y Yellow
 O Orange
 B Blue
 W White

▲ Lamp voltage
 Blank Non-illum.
 05D dot - 5VDC
 12D dot - 12VDC
 24D dot - 24VDC
 05T thin ring - 5VDC
 12T thin ring - 12VDC
 24T thin ring - 24VDC

05L large ring - 5VDC
 12L large ring - 12VDC
 24L large ring - 24VDC



Shower
(IP68 sealing)



Home automation
(design, customization)



Bath
(IP68 sealing, customization)



Car wash
(IP68 sealing, long life)



Marine
(IP68 sealing, design)



Medical
(easy to clean surface, no retention area)



Food processing
(IP68 sealing)



Mining
(IP68 sealing)